



Now covering  
metal stud and  
block walling  
with LPCB  
certification

## Securilath™: the versatile target hardening solution

### Why Securilath™?

As doors and windows have been 'target hardened' by grilles, shutters and alarms, would-be intruders have turned their attention to forced entry through walls, partitions, ceilings and roofs.

To counteract this, the ExMesh™ Securilath™ system has been developed as a discreet method of significantly delaying the most determined intruder from creating an aperture large enough to gain entry into a property.

Manufactured by The Expanded Metal Company, Securilath™ can be installed at the time of construction onto internal and external walls (solid or stud), ceilings and roofs, or can be retrofit whilst refurbishment is carried out. The option of finishing with dry lining or render is not lost with Securilath™, as our range covers both options.

### Typical Securilath™ applications

- ◆ Cash handling stores
- ◆ Wholesale & retail outlets
- ◆ Control rooms
- ◆ Petrol station kiosks
- ◆ Firearm stores
- ◆ Hightech classrooms & laboratories
- ◆ High value goods stores
- ◆ Computer rooms and data centres
- ◆ Secure units
- ◆ Remote facility security
- ◆ Pharmaceutical stores
- ◆ Museums & galleries



LPS 1175: Issue 8  
Cert No. 731n

Although the typical focus is on protecting high value property, it makes sense to specify Securilath™ as a standard preventative measure in all security packages.

# Installation, application and fixing details

Securilath™ is easily fixed to brickwork, blockwork, stud partitioning, ceiling joists and roofs in metal or timber. It is important to note that Securilath™ sheets should be butted together and not overlapped. Suggested fixings for popular applications are shown below. For additional security we suggest reducing the spacing shown when Securilath™ is fixed adjacent to doors or windows.

## Timber stud walls and ceiling joists/rafters

Securilath™ fixed to stud with 30-38mm galvanised staples, 30-38mm galvanised screwnails, or 65mm x 3.35mm bright annular nails (to BS1202) and min 25mm dia x 1.5mm galvanised washers fixed at maximum 450mm centres.\*

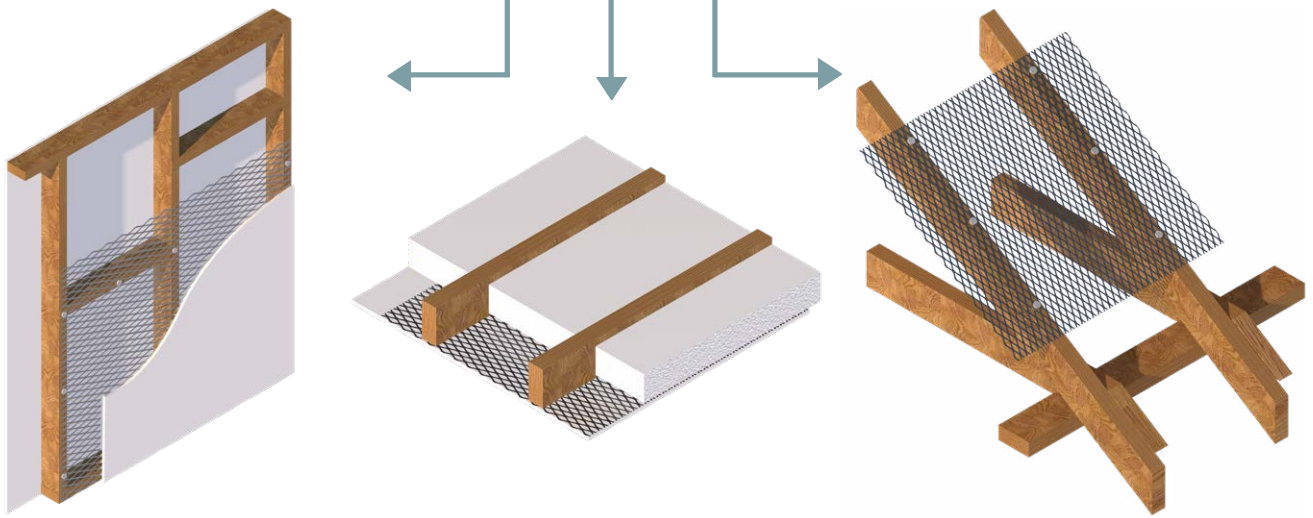

## Metal stud walls, purlins and roofs

Securilath™ fixed to metalwork with No. 6 or 8 x 30 zinc plated self tapping screws, complete with min 25mm dia x 1.5mm galvanised washers fixed at maximum 450mm centres.\*



## Brick or blockwork applications

Suitable for both render and plaster finishes. Securilath™ HDR mesh fixed with M6 plug and M6 x 50mm screw complete with minimum 25mm dia x 1.5mm galvanised washers at maximum 450mm centres in both directions.\*

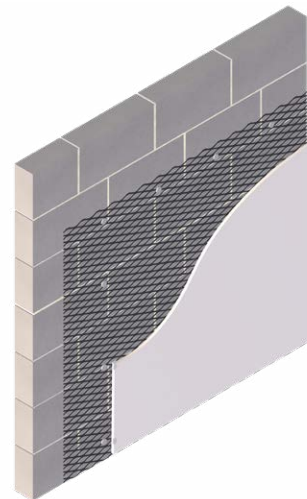

## Facing fixings

We suggest that plasterboard facing is fixed onto Securilath™ and stud using bugle head drywall screw fixings PN2 3.5 x 55 BZP at maximum 450mm centres. Plywood should be fixed using 4.5mm x 50mm BZP or passivated wood screws at maximum 450mm centres.

\*LPCB ratings are only achieved when installing the Securilath™ mesh onto block and timber/metal stud to fitting instructions (available upon request).



ATTACK FACE	MESH	STUD WALL*	MESH	NON ATTACK FACE	TESTED LEVEL*
12mm Plasterboard	HD1	Metal or Timber	-	12mm Plasterboard	SR1
18mm Plywood	MD1	Metal or Timber	-	12mm Plasterboard	SR1
18mm Plywood	HD1	Metal or Timber	-	12mm Plasterboard	SR2
18mm Plywood	HD1	Metal or Timber	HD1	18mm Plywood	SR3

\*Further details can be found on [www.redbooklive.com](http://www.redbooklive.com)

ATTACK FACE	MESH	BLOCK WALL	TESTED LEVEL
Tested without a face finish. Can be rendered, Drylined or faced with plywood.	HDR	Min 140mm Medium Density Block	SR3

**Securilath™ has been tested by BRE's Loss Prevention Certification Board (LPCB) to Standard LPS 1175.**  
**Further details can be found on [www.redbooklive.com](http://www.redbooklive.com)**

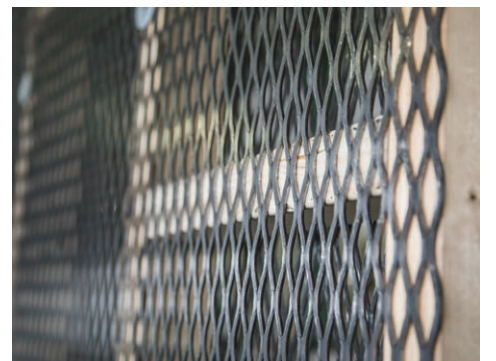

## Technical information

Mesh	Application	Description	Finish Options	Weight kg/m2 untreated	Size
<b>Securilath™ MD1</b>	Lighter weight option for security in walls and partitions	1.2mm thick flattened mesh	Mild steel, galvanised, painted	1.85	2440mm x 1220mm
<b>Securilath™ HD1</b>	Heavyweight option for security in walls and partitions	3mm thick flattened mesh	Mild steel, galvanised, painted	8.59	2440mm x 1220mm
<b>Securilath™ Ultra</b>	<b>Double skinned</b> option for extra security in walls and partitions (HD1 x 25 sheets)	3mm thick flattened mesh	Mild steel, galvanised, painted	8.59	2440mm x 1220mm
<b>Securilath™ HDR</b>	Internal / external brick or block walls. Provides an excellent key for plaster / render finishes	3mm thick standard profile mesh raised edge for rendering	Mild steel, galvanised, painted	6.52	2440mm x 1220mm



# RIDGEWAY

Web: [www.ridgewayindustrial.com](http://www.ridgewayindustrial.com)

Email: [info@ridgeway-online.com](mailto:info@ridgeway-online.com)

UK:-  
103 Airport Road West  
Belfast  
BT3 9ED  
Tel: +44 (0) 28 9045 4599

Ireland:-  
Units 1&2 Greene Park  
Ratoath Road  
Ashbourne  
Co. Meath  
A84 XD98  
Tel: +353 (01) 802 7173

### LPCB certification

Securilath™ has undergone rigorous testing to achieve LPCB security accreditation.

In order to achieve this standard, Securilath™ must be installed to replicate the test panels.

Details of the standards obtained and installation details are available in a separate guide (available upon request).



LPS 1175: Issue 8  
Cert No. 731n

